

.....

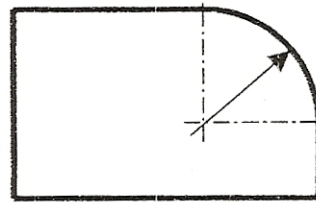

.....

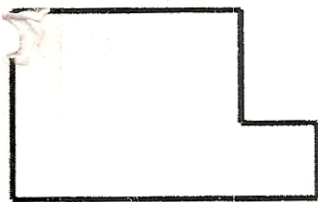

.....

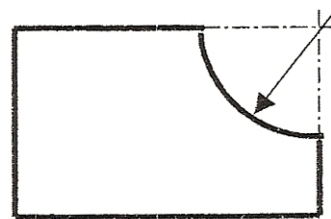

.....

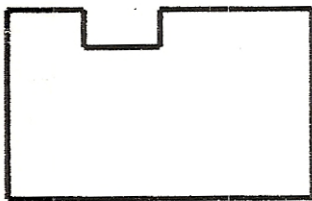

.....

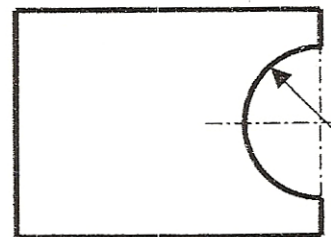

.....

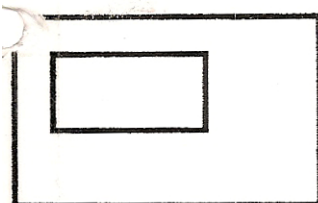

.....

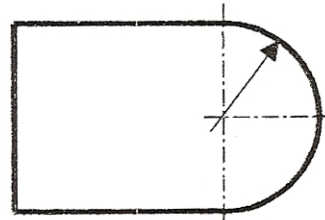

.....

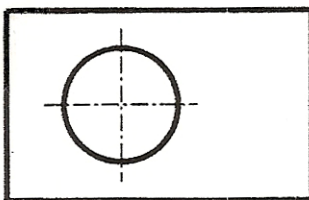

.....

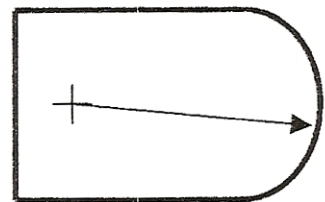

.....

Abschrägung ≙ Durchbruch ≙ Nut ≙ Stufe ≙ Einrundung 90° ≙ Einrundung 180° ≙ Teilab-
 rundung ≙ Bohrung ≙ Abrundung 90° ≙ Abrundung 180°

